



A PLACE BEYOND COMPARE

Edgewood Tahoe Resort™ is a meeting destination that knows no peer. An all-encompassing alpine retreat that inspires adventurous, blue-sky thinking and rewards it with life-affirming moments of natural wonder and world-renowned indulgence. With up to 7,000 square feet of state-of-the-art scalable meeting spaces throughout the Lodge and Clubhouse, 154 alpine-inspired rooms and suites, Edgewood Tahoe is equipped to accommodate meetings ranging from personal to grand. Committed not just to sharing Tahoe's majestic environment, but to protecting it through sustainability practices and state-of-the-art LEED-certified engineering.

This is where you meet amazement.



MAJESTIC LOCATION

Located on the edge of the pristine Tahoe blue waters, Edgewood Tahoe is the only true lakeside resort in the region. Lake Tahoe offers breathtaking views and endless year-round activities including golfing, water sports, hiking, world-class winter sports, ice skating and more. Edgewood Tahoe's close proximity to South Lake Tahoe's entertainment district makes it the ideal location to enjoy gaming, nightlife and shopping. From adventure seekers to lakefront lounging, Edgewood Tahoe has something for everyone.



154 guest rooms and suites

3,000-square-foot ballroom

Lakefront clubhouse featuring event spaces

Spacious beach front event lawn

3 distinct dining experiences

18-hole lakeside golf course

8,500-square-foot, full service spa and salon

Year-round lake and mountain activities

State-of-the-art LEED Silver certified Lodge

Forbes Travel Guide 4-Star Rated Lodge and Spa



A HISTORY OF HOSPITALITY

Nearly 150 years ago, the Park family forged a life in the rugged American West as cattle ranchers. The rich resources and beauty of Lake Tahoe were not lost on them. With a pioneering spirit and a vision of deep-reaching community roots, service, and environmental stewardship, Edgewood Tahoe was born.

LOCATION DISTANCES

| City | Reno | Sacramento | San Francisco | San Jose | Los Angeles | Las Vegas |
|----------------------------|------|------------|---------------|----------|-------------|-----------|
| DISTANCE (MILES) | 56 | 117 | 202 | 220 | 444 | 453 |
| DRIVING TRAVEL TIME (H:MM) | 0:58 | 2:05 | 3:26 | 3:35 | 8:18 | 6:50 |

THE ROOMS



TAHOE ROOM

- 500-Square-Foot Room
- King or Double Queen Options
- Mountain View or Lakeview Options
- Terrace / Balcony with Seating Area
- Connecting Rooms Available
- Soaking Tub
- Separate Walk-in Shower
- In-Room Gas Fireplace
- In-Room Refrigerator
- Keurig Coffee Maker
- Frette Robes
- Premium Linens

TAHOE PREMIER ROOM

- 750-Square-Foot Room
- King or Double Queen Options
- Mountain View or Lakeview Options
- Terrace / Balcony with Seating Area
- Additional Seating Area
- Connecting Rooms Available
- Soaking Tub
- Separate Walk-in Shower
- In-Room Gas Fireplace
- In-Room Refrigerator
- Keurig Coffee Maker
- Frette Robes
- Premium Linens



THE ROOMS



EDGEWOOD SUITE

1,000-Square-Foot Room

King Bed

Golf or
Lakeview Options

Terrace / Balcony
with Seating Area

Separate Living Room with Sleeper
Sofa / Pull Out Bed

Additional Guest Bathroom

Connecting Rooms Available

Soaking Tub

Separate Walk-in Shower

In-Room Gas Fireplace

In-Room Refrigerator

Nespresso Coffee Maker

Frette Robes

Premium Linens

Additional In-Room Amenities
Available Upon Request

Accessible Rooms
Available Upon Request

EMERALD SUITE

1,500-Square-Foot Room

King Bed

Balcony with Seating Area

Separate Living Room with
Sleeper Sofa / Pull Out Bed

Additional Guest Bathroom

Butler's Pantry

Complimentary Web Bar

Connecting Rooms Available

Soaking Tub

Separate Walk-in Shower

In-Room Gas Fireplace

In-Room Refrigerator

Nespresso Coffee Maker

Frette Robes

Premium Linens





MAP KEY

| | | | |
|----------|------------|----------|------------|
| 1 | NORTH ROOM | 4 | SOUTH ROOM |
| 2 | NORTH DECK | 5 | SOUTH DECK |
| 3 | NORTH LAWN | 6 | SOUTH LAWN |

EDGEWOOD TAHOE CLUBHOUSE

| Room | Sq. Ft. | Max Ht. | Conf. | Banquet | Classroom | Reception | U-Shape | Hollow Square | Theater | Crescent |
|------------|---------|---------|-------|---------|---------------------|-----------|---------|---------------|---------|----------|
| NORTH ROOM | 2,496 | 22 FT | 30 | 160 | 70 50 with stage | 160 | 24 | 26 | 100 | 100 |
| NORTH DECK | - | - | - | - | - | - | - | - | - | - |
| NORTH LAWN | - | - | - | - | - | - | - | - | - | - |
| SOUTH ROOM | 1,644 | 22 FT | 30 | 100 | 68 | 100 | 24 | 26 | 100 | 60 |
| SOUTH DECK | - | - | - | - | - | - | - | - | - | - |
| SOUTH LAWN | - | - | - | - | - | - | - | - | - | - |

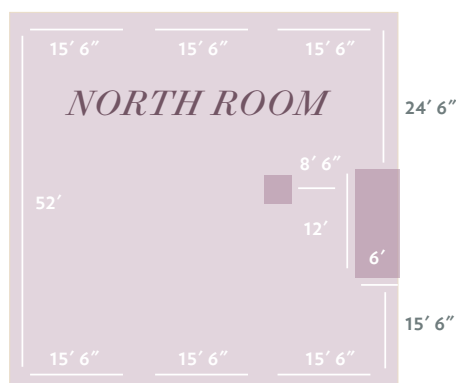
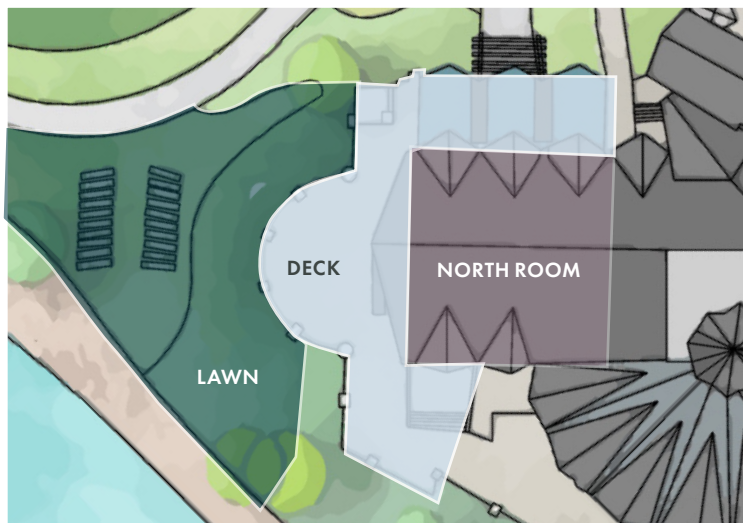

- 2,500 sq ft.
- 160 guest capacity

NORTH ROOM, DECK & LAWN

Offering approximately 2,500 sq. ft. of expansive and customizable space, the North Room is the largest of two available spaces inside our clubhouse. With floor-to-ceiling windows that offer majestic views of tahoe's sapphire waters and the surrounding Sierra mountains, the North Room at Edgewood Tahoe makes for a spectacular gathering space for corporate events.

With a design aesthetic inspired by the innate beauty found in the area's natural surroundings, the north room boasts vaulted wood-beam ceilings and striking stone work—creating a balance that feels both refined and warm, both serene and welcoming.

The North Room can accommodate up to 150 guests inside, and expand with the deck and lawn in warmer months.



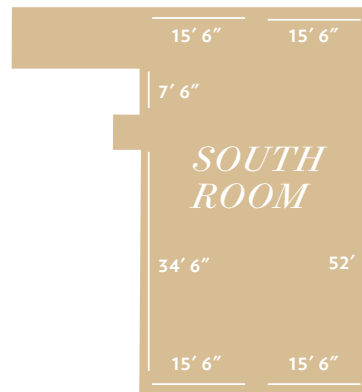
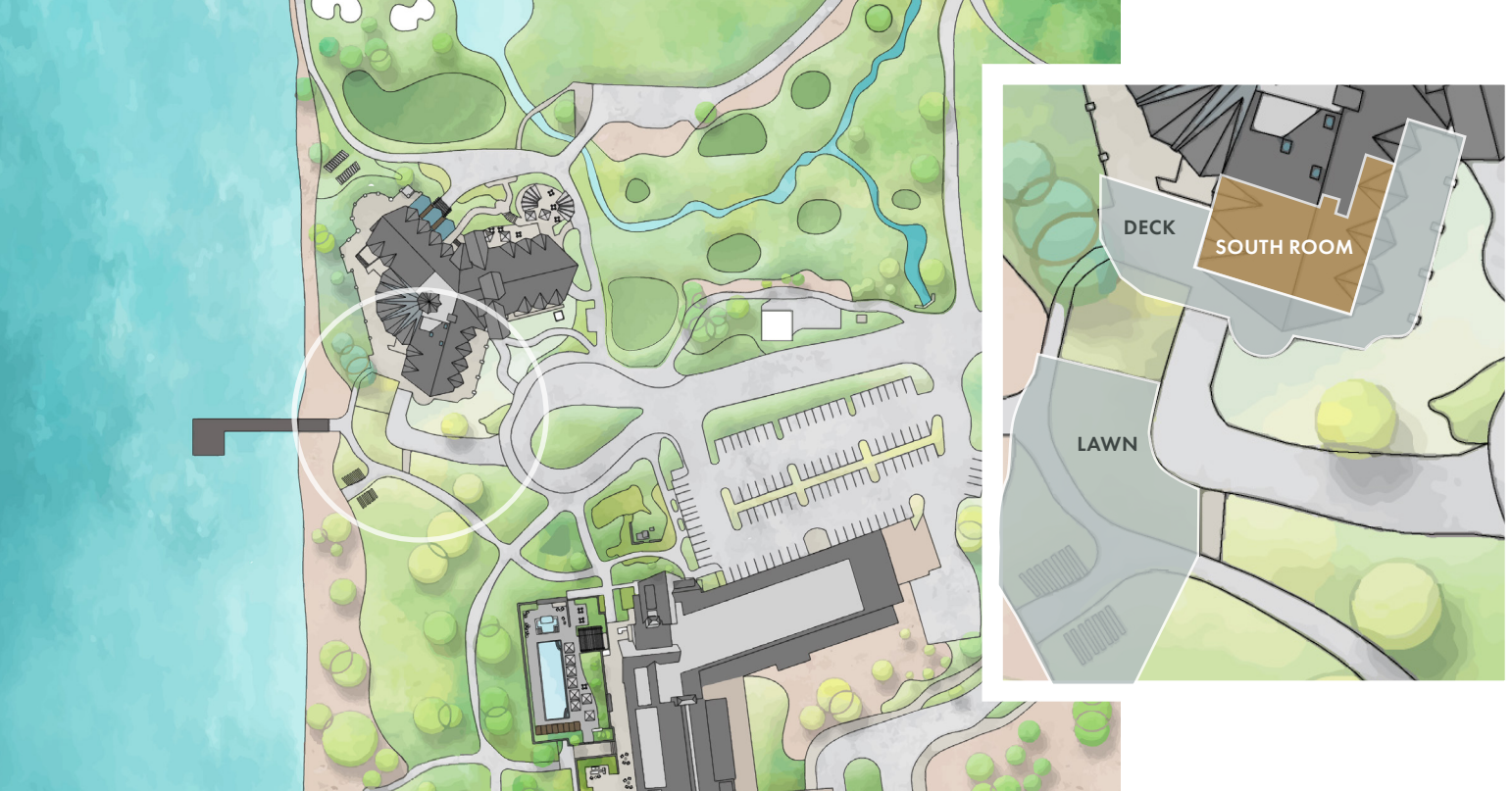

- 1,650 sq. ft.
- 100 guest capacity

SOUTH ROOM, DECK

The more intimate of the two event spaces located inside our iconic Clubhouse, the South Room at Edgewood Tahoe offers approximately 1,700 sq. ft. of spectacular, customizable space for your upcoming event. With floor-to-ceiling windows offering majestic views of towering pines and waters of Lake Tahoe, the South Room makes for a stunning space for everything from corporate dinners to welcome receptions.

Inspired by the natural beauty of the surrounding Sierras, the South Room showcases striking wood ceilings and lots of natural light—creating a gathering space that feels warm, welcoming, and absolutely organic. The South Room also includes direct access to an adjacent patio and fire-pit.

The South Room can accommodate up to 100 guests inside, and expand with the deck in warmer months.

THE LODGE AT EDGEWOOD TAHOE

| Room | Sq. Ft. | Max Ht. | Conf. | Banquet | Classroom | Reception | U-Shape | Hollow Square | Theater | Crescent |
|--|---------|---------|-------|---------|-----------|-----------|---------|---------------|---------|----------|
| LODGE BALLROOM 1* | 1,053 | 11 FT. | 24 | 50 | 44 | 80 | 20 | 22 | 80 | 50 |
| LODGE BALLROOM 2* | 858 | 11 FT. | 20 | 40 | 32 | 30 | 10 | 12 | 40 | 20 |
| LODGE BALLROOM 3* | 1,053 | 11 FT. | 24 | 50 | 44 | 80 | 20 | 22 | 80 | 50 |
| BALLROOM PRE-FUNCTION | 1,512 | 11 FT. | - | - | - | - | - | - | - | - |
| BOARDROOM | 418 | 11 FT. | 12 | - | - | - | - | - | - | - |
| BEACH FRONT LAWN | - | - | - | - | - | - | - | - | - | - |
| * CAN BE COMBINED TOGETHER FOR A TOTAL OF 2,964 SQ. FT. OUTSIDE SPACES DEPENDENT ON WEATHER CONDITIONS | | | | | | | | | | |

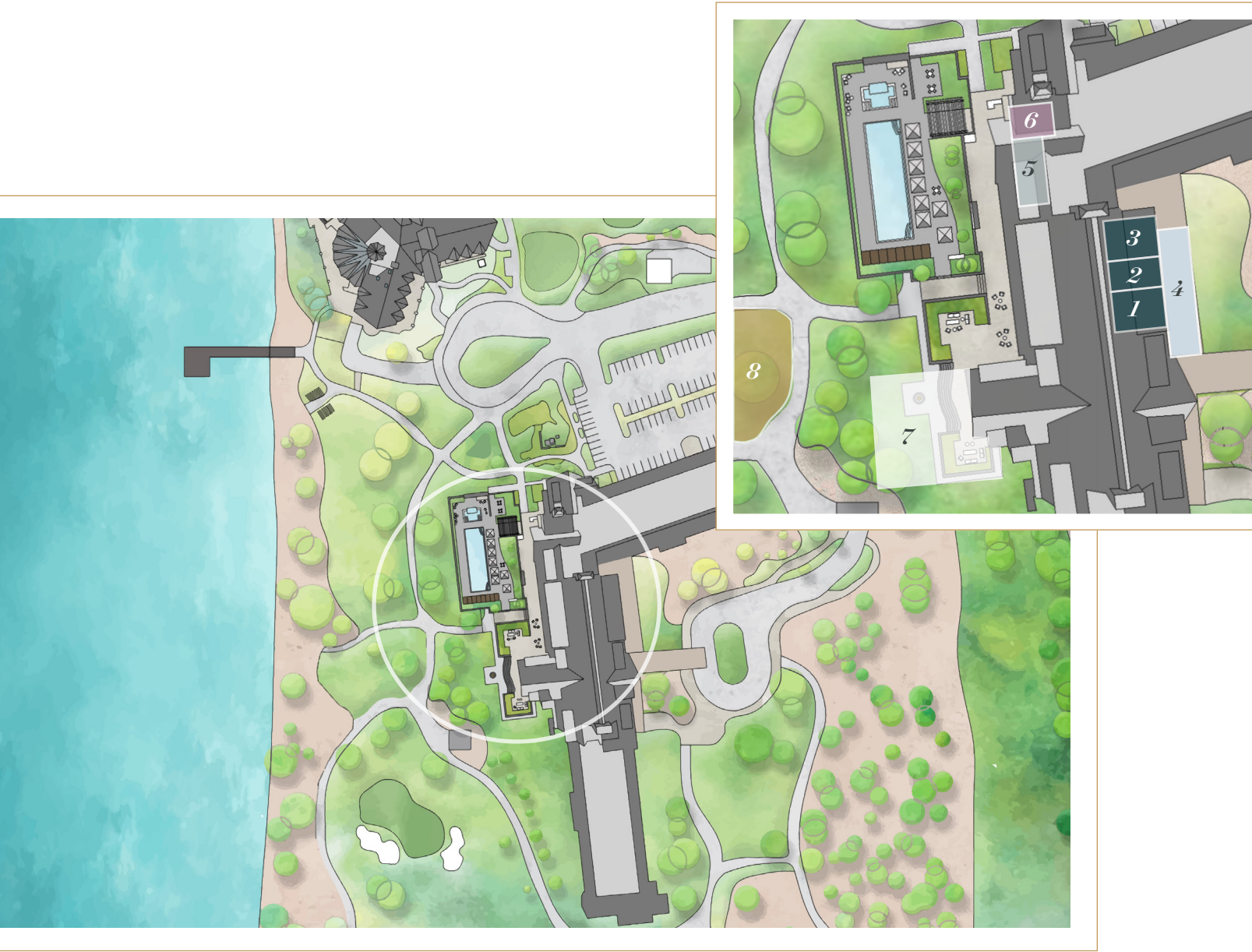

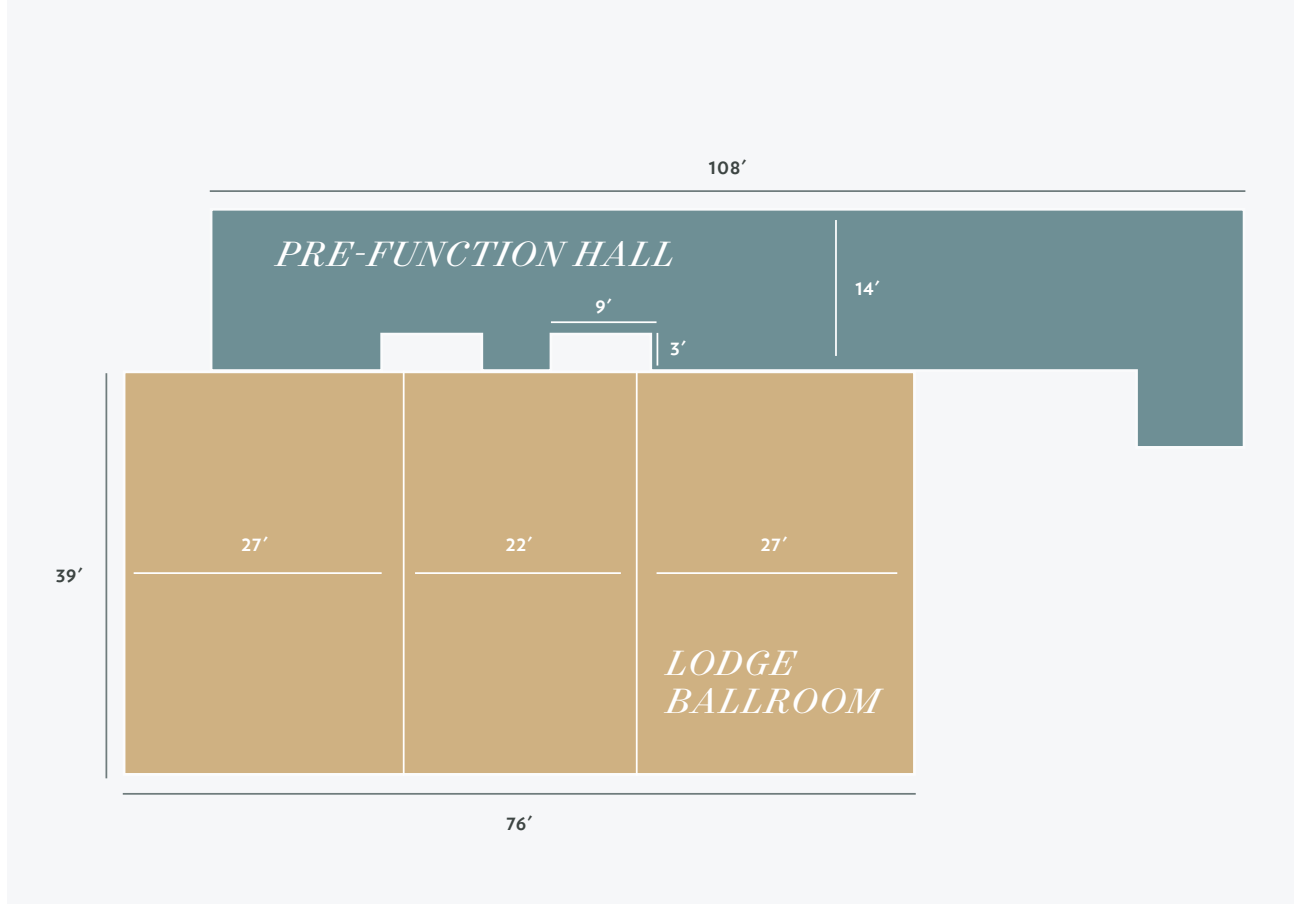

BALLROOM & PRE-FUNCTION

The Lodge ballroom is a flexible space, ranging from approximately 860 to 3,000 sq. ft. It is located on the first floor of the Lodge, and is excellent for all sizes of meetings and events. This space can be divided into three breakout rooms, or it can encompass the entire space to accommodate larger gatherings.

Functions held in the ballroom can also utilize the 1,500 sq. Ft. pre-function hall. The hall is lined with windows to allow soothing outside light in. It also has several exit doors that can be opened to a patio to let your guests explore outside for fresh mountain air.

A full private bar is available to serve your guests at the end of the hall.

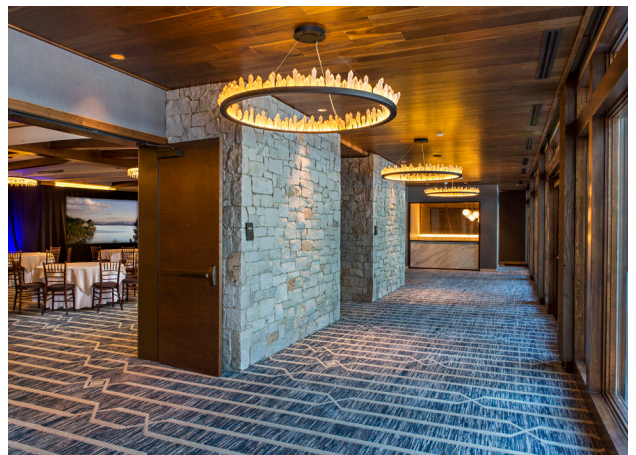

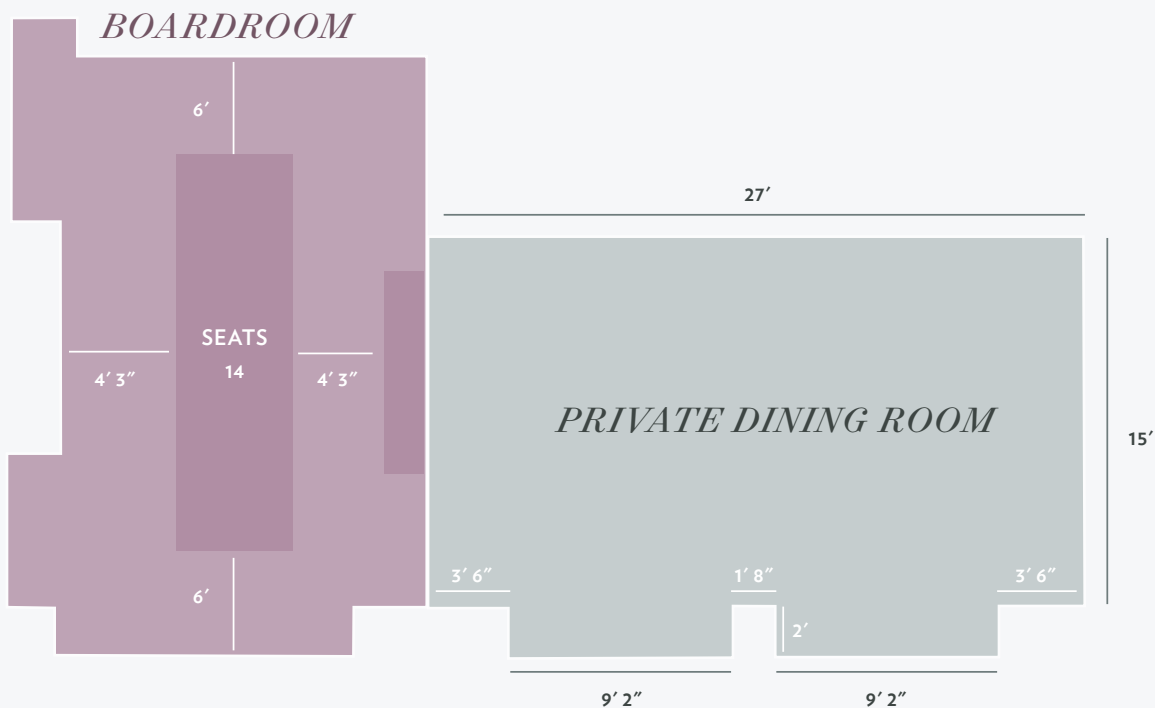

PRIVATE DINING & BOARDROOM

Located on the first floor of the Lodge is The Bistro Restaurant and two private rooms perfect for executive groups.

The private dining room can comfortably accommodate up to 32 guests, has views looking out to the pool and lake, and has two sets of doors.

The boardroom can comfortably seat up 12 - 14 guests at the gorgeous solid wood table in the center of the room. This space also includes a gas fireplace, and small private bathroom.



At Encore Global, we blend creativity and innovative technology for an inspiring experience. Our highly trained professionals are passionate about delivering exceptional experiences to help you tell your story. With a focus on every aspect of your event, from planning to execution, we'll bring your vision to life.

POPULAR PACKAGES

Meeting Room Projector Package — \$680

- AV cable lot
- Projection stand
- LCD projector
- Tripod Screen

Wireless microphone package — \$410

- Wireless microphone lavalier or handheld
- Meeting room house sound system
- 4-channel mixer

Podium Microphone Package — \$260

- Podium microphone
- Meeting room house sound
- 4-channel mixer

Laptop/MP3 Audio Package — \$185

- 4-channel mixer sound with 1/8" audio adapter
- Meeting room house

Projector Support Package — \$200

- AV cable lot
- Projection stand
- Tripod screen

Post-it® Flip Chart package — \$96

- Flip chart easel
- Post-it flip chart pad
- Markers

Flip Chart Package — \$76

- Flip chart easel
- Flip chart pad
- Markers

SMALL MEETING

- Conference speaker phone \$180
- Laptop computer \$250

AUDIO

- Powered speaker \$120
- Presidential microphone \$90
- Wired microphone \$70
- Wireless microphone \$220
- 4-channel mixer \$75
- 12-channel mixer \$155

LIGHTING

- LED wash light \$95
- 6 up-lights \$900
- 10 up-lights \$1,280

SCENIC

- 10' Décor drapery \$175

VIDEO

- 46" to 55" Monitor \$510

STANDARD LABOR RATES*

- Setup/Strike \$100
- Event Operation \$115

To learn about our creative and production services, please contact your Encore representative.

CONTACT

Peter Sereno
Edgewood Tahoe Resort
100 Lake Parkway, Lake Tahoe, NV 89449
office: 775.745.8455 | www.encoreglobal.com
peter.sereno@encoreglobal.com



* Ask your representative for full details regarding labor rates, which can vary based on complexity and time of operation. All encore solutions may be subject to our property's administrative fee. Above prices do not reflect labor charges which may apply. All rates are subject to applicable sales tax.